

WEST DORSET DISTRICT COUNCIL

TOWN AND COUNTRY PLANNING ACT 1971

TOWN AND COUNTRY PLANNING GENERAL DEVELOPMENT ORDER 1973

DIRECTION UNDER ARTICLE 4 OF THE TOWN AND COUNTRY
PLANNING GENERAL DEVELOPMENT ORDER 1973 RELATING
TO LAND AT CHURCH FARM, BROADMAYNE IN THE COUNTY
OF DORSET

WHEREAS

(1) The West Dorset District Council (hereinafter called "the Council") are the District Planning Authority for their district by virtue of the provisions of the Town and Country Planning Act 1971 (hereinafter called "the Act") as amended by the Local Government Act 1972

(2) The Council are satisfied that it is expedient that development of the description set out in the First Schedule hereto should not be carried out on the land described in the Second Schedule hereto unless permission therefore is granted on an application in that behalf

NOW THEREFORE the Council in accordance with their powers and by virtue of Article 4 of the Town and Country Planning General Development Order 1973

HEREBY DIRECT that the permission granted by Article 3 of the said Order shall not apply to development on the land described in the Second Schedule hereto of the descriptions set out in the First Schedule hereto.

FIRST SCHEDULE

Any development of the kinds specified in the following Class of the First Schedule to the said Order, namely :-

"Class VI, 1. - Agricultural buildings, works and uses.

The carrying out on agricultural land having an area of more than one acre and comprised in an agricultural unit of building or engineering operations requisite for the use of that land for the purposes of agriculture (other than the placing on land of structures not designed

for those purposes or the provision or alteration of dwellings) so long as :-

(a) the ground area covered by a building erected pursuant to this permission does not, either by itself or after the addition thereto of the ground area covered by any existing building or buildings (other than a dwelling house) within the same unit erected or in course of erection within the preceding two years and wholly or partly within 90 metres of the nearest part of the said building, exceed 465 square metres.

(b) the height of any buildings or works does not exceed 3 metres in the case of a building or works within 3 kilometres of the perimeter of an aerodrome, nor 12 metres in any other case.

(c) no part of any buildings (other than moveable structures) or works is within 25 metres of the metalled portion of a trunk or classified road. "

SECOND SCHEDULE

All those parcels of land being OS Nos. 3548, 4553 and 5544 Church Farm, Broadmayne in the County of Dorset as the same are shown edged green on the plan annexed hereto GIVEN under the Common Seal of the West Dorset District Council this

day of *3 July* 1975

THE COMMON SEAL of the WEST DORSET)
DISTRICT COUNCIL was hereunto affixed)

in the presence of :

[Redacted Signature]

Chairman of the Council

[Redacted Signature]

Chief Executive

452/75

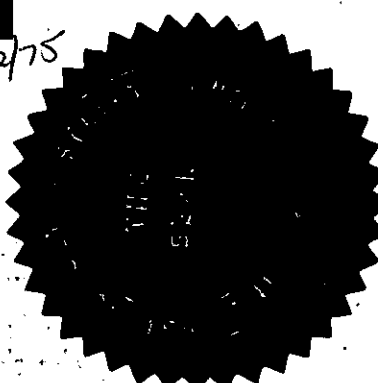

DOE 20998

The Secretary of State for the Environment
hereby approves the foregoing direction.

Signed by authority
of the Secretary of
State

An Assistant Secretary
in the Department of
the Environment.

Line
12 SEPTEMBER 19 75

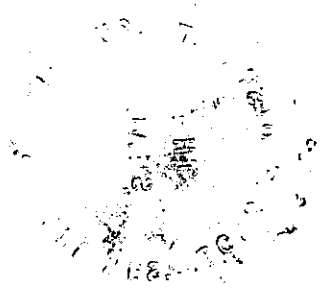

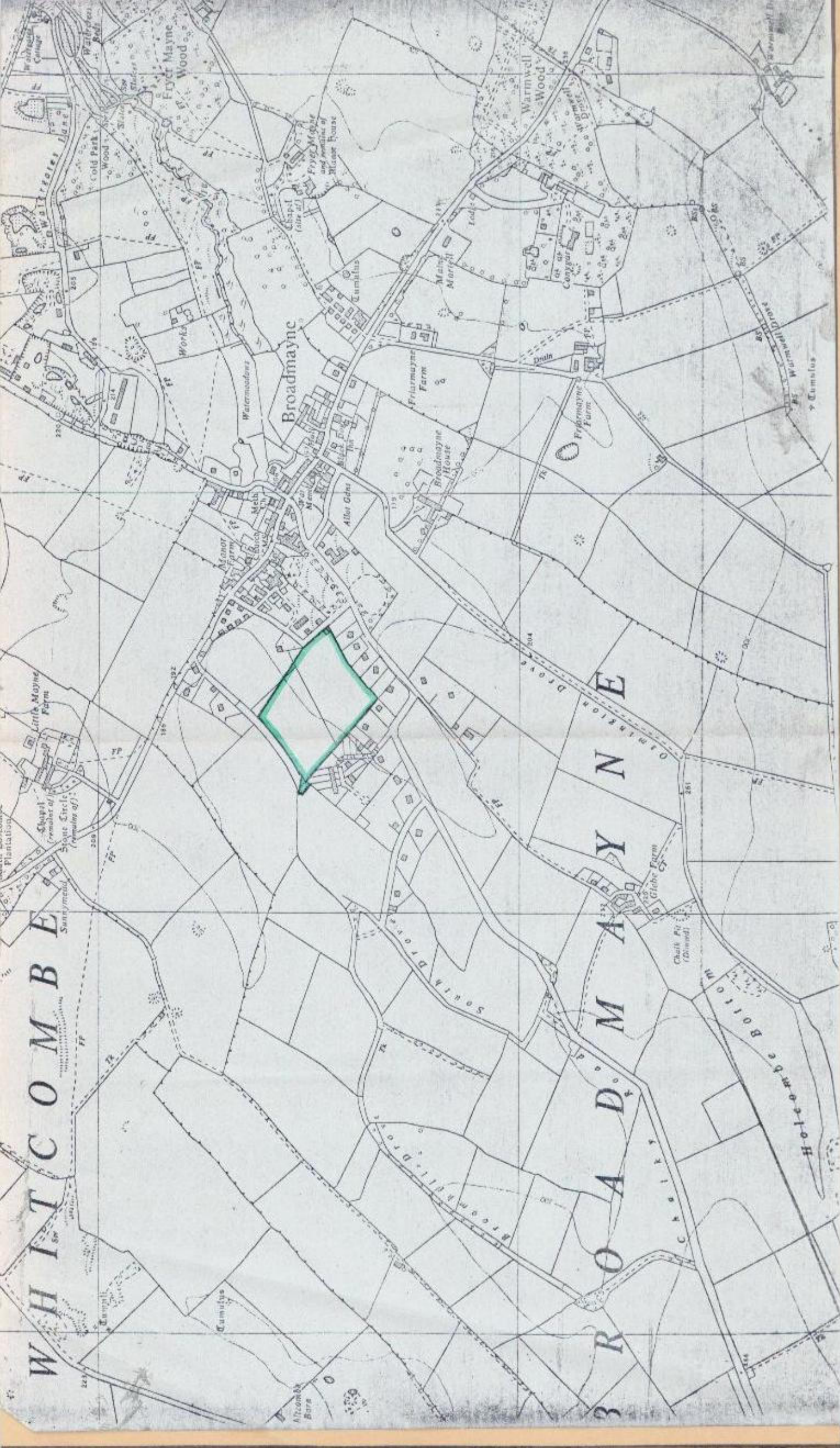
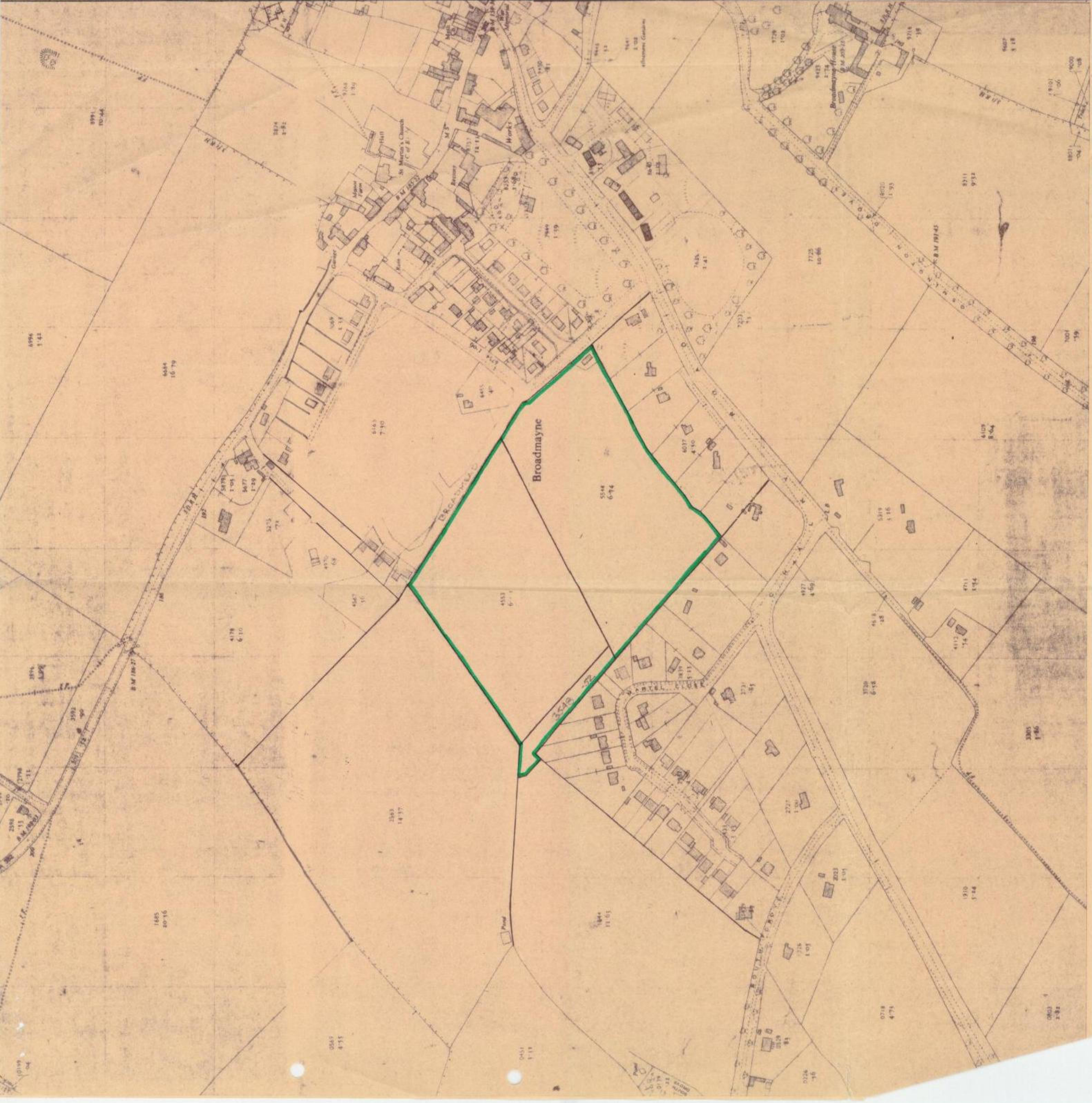

TOWN & COUNTRY PLANNING GENERAL DEVELOPMENT ORDER 197

PROPOSED ARTICLE 4 DIRECTION AT

CHURCH FARM, BROADMAYNE

KEY



LAND COVERED BY PROPOSED
DIRECTION

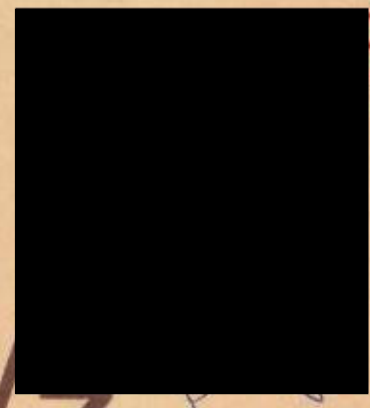
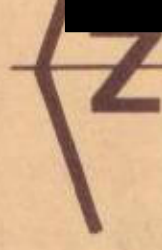

SCALE 1:2500

SCALE OF LOCATION INSET 1:10,560